



THRONATEESKA HERITAGE FOUNDATION, INC.
100 WEST ROOSEVELT AVENUE
ALBANY, GEORGIA 31701
229-432-6955 FAX: 229-435-1572
www.heritagecenter.org

RENTAL AMENITIES LIST – CHAUTAUQUA ROOM

REV. 08/16/2017

General Equipment

Podium (Wooden)

United States of America Flag

For use with the Chautauqua Room & Platform

Kitchen Equipment

Food Prep Sink

3-Compartment Pot & Pan Sink

Hand Wash Sink

1,000 Watt Microwave

2-Door Commercial Refrigerator

6-Burner Range with Oven (Gas)

Humidified Hot Holding Cabinet

Ice Machine (300 pounds)

Stainless Steel Prep Tables

Storage Shelving

Tables & Chairs

8 – 72” Rectangular Tables

8 – 60” Round Tables

2 – 40” Square Tables

4 – 48” Round Tables

92 Chairs



THRONATEESKA HERITAGE FOUNDATION, INC.
 100 WEST ROOSEVELT AVENUE
 ALBANY, GEORGIA 31701
 229-432-6955 FAX: 229-435-1572
 www.heritagecenter.org

CHAUTAUQUA ROOM EVENT LAYOUT

REV. 08/16/2017

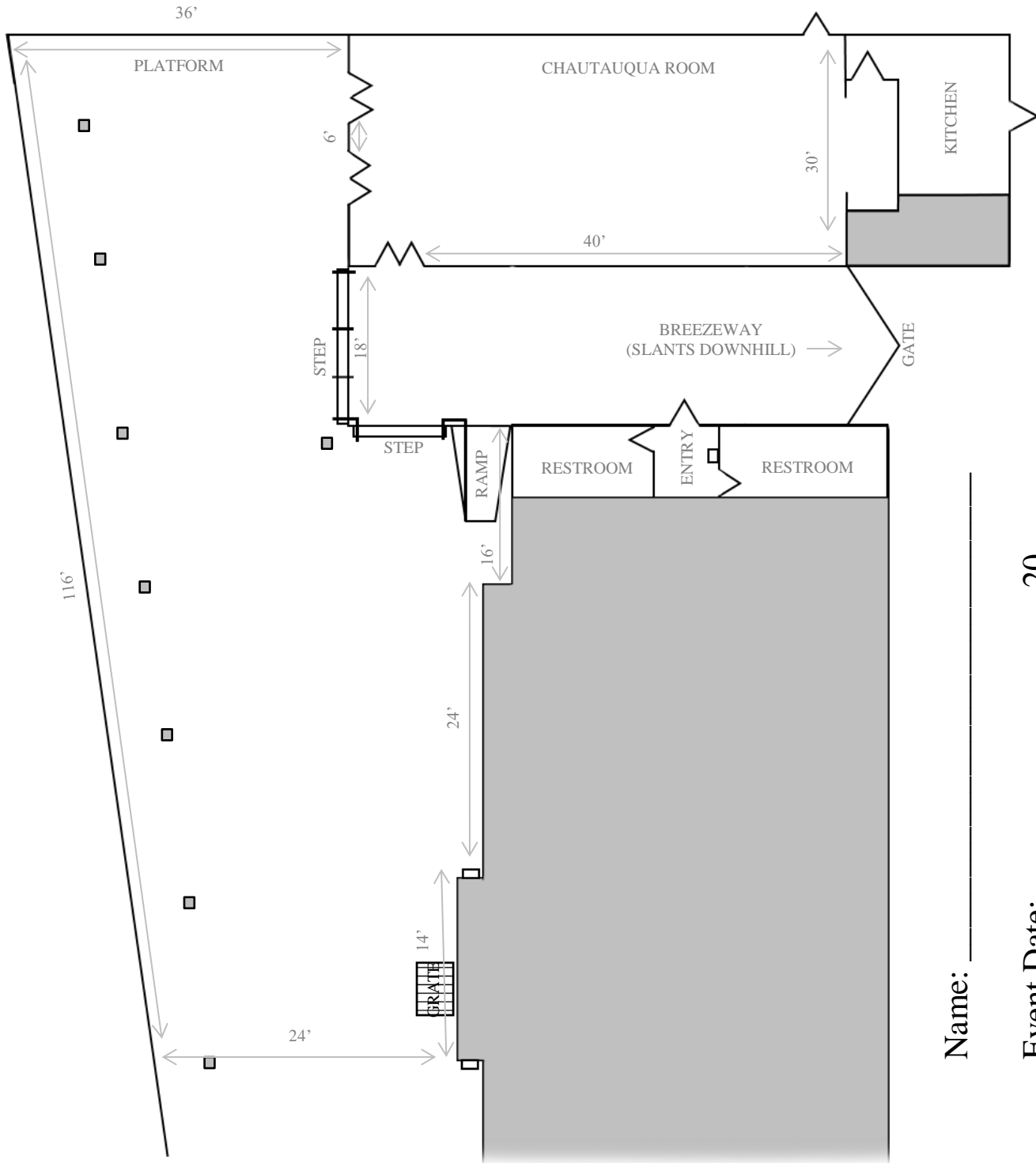

Name: _____
 Event Date: _____, 20____

Thronateeska Heritage Center is a 501(c)3 not-for-profit.



THRONATEESKA HERITAGE FOUNDATION, INC.
100 WEST ROOSEVELT AVENUE
ALBANY, GEORGIA 31701
229-432-6955 FAX: 229-435-1572
www.heritagecenter.org

RENTAL AMENITIES LIST – SCIENCE MUSEUM & WETHERBEE PLANETARIUM

REV. 08/16/2017

General Equipment

Podium (Wooden)

United States of America Flag

For use with the Science Museum & Wetherbee Planetarium

Science Museum

Interactive Exhibits

Bleacher Seating Area

Audio/Visual Displays

1 – 72” Rectangular Table

Limited chairs (depending on planetarium use)

Wetherbee Planetarium

36 – Fixed Seats

40 – Moveable Seats

Custom Audio/Visual Capabilities



THRONATEESKA HERITAGE FOUNDATION, INC.
100 WEST ROOSEVELT AVENUE
ALBANY, GEORGIA 31701
229-432-6955 FAX: 229-435-1572
www.heritagecenter.org

SCIENCE MUSEUM & PLANETARIUM EVENT LAYOUT

REV. 08/16/2017

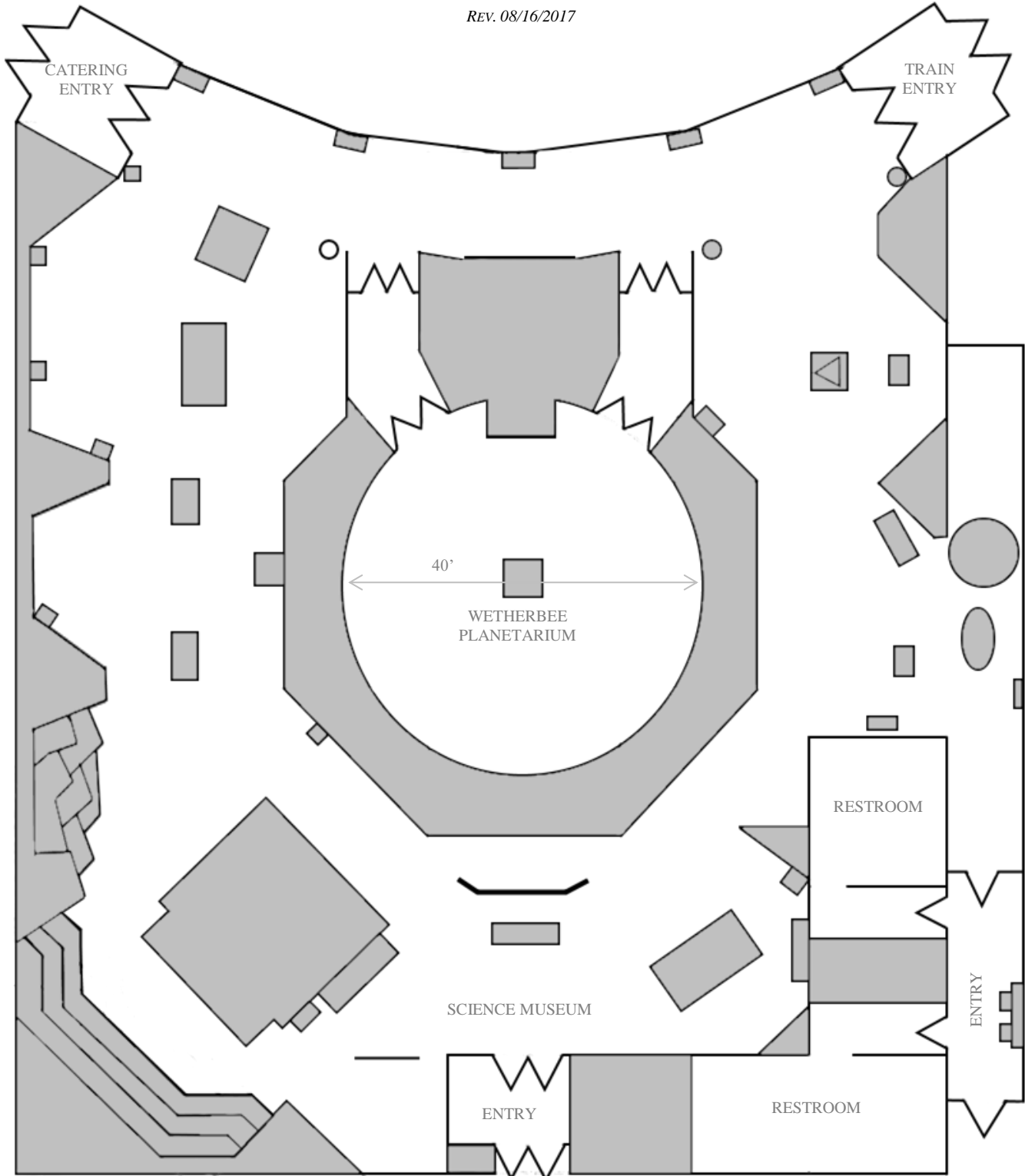

Thronateeska Heritage Center is a 501(c)3 not-for-profit.

WETHERBEE PLANETARIUM – SCIENCE & HISTORY MUSEUMS – GEORGIA MUSEUM OF SURVEYING & MAPPING – SOUTH GEORGIA ARCHIVES